

The Switcher

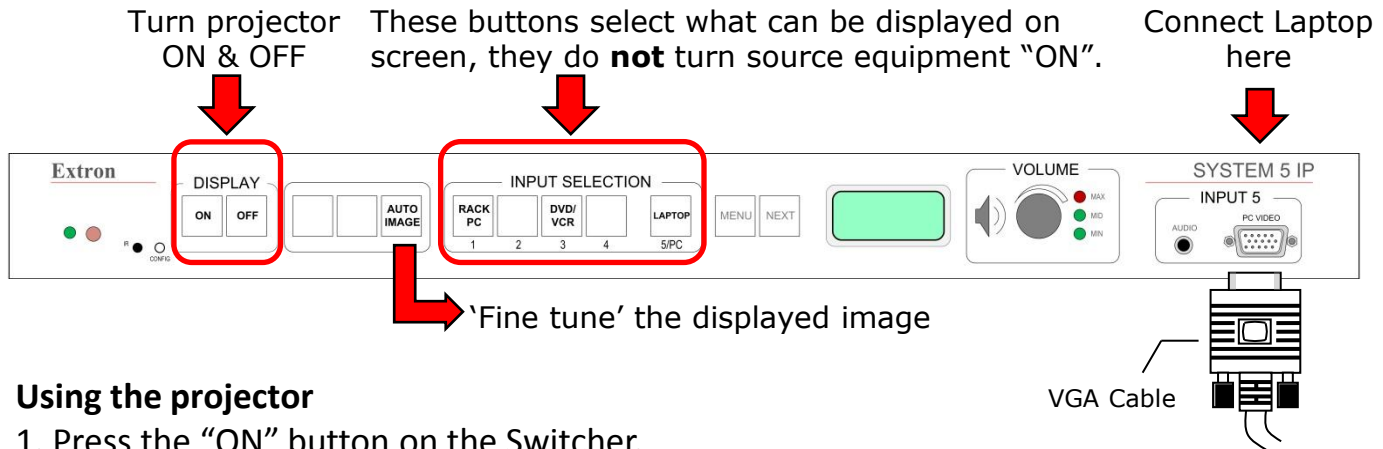

Using the projector

1. Press the "ON" button on the Switcher.
2. Press the "INPUT SELECTION" button that corresponds with the video source (Rack PC, DVD/VCR, or laptop) that you want to use.
3. When you are finished press the "OFF" button on the Switcher.

Connecting your laptop

1. Plug the VGA cable (located in one of the two drawers) into the LAPTOP port on the Switcher as shown.
2. Turn on, and boot up your Laptop.
3. Press the Input Selection button labeled "LAPTOP" on the Switcher.

The User Interface Panel

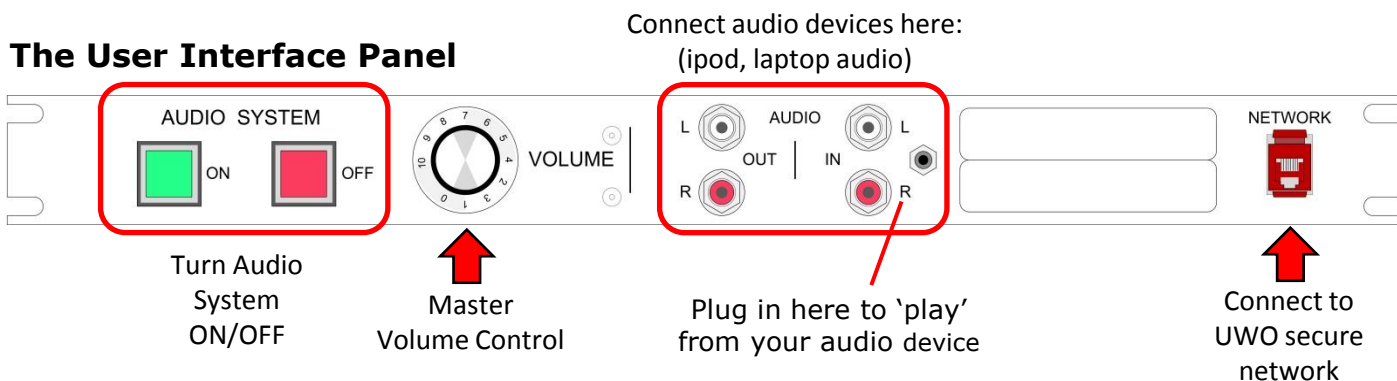

Using the audio system

1. Press the GREEN "ON" button on the User Interface Panel.
2. Adjust the master audio level of the sound system using the VOLUME knob.
3. When you are finished press the RED "OFF" button to turn the audio system off.

The Computer (RACK PC)

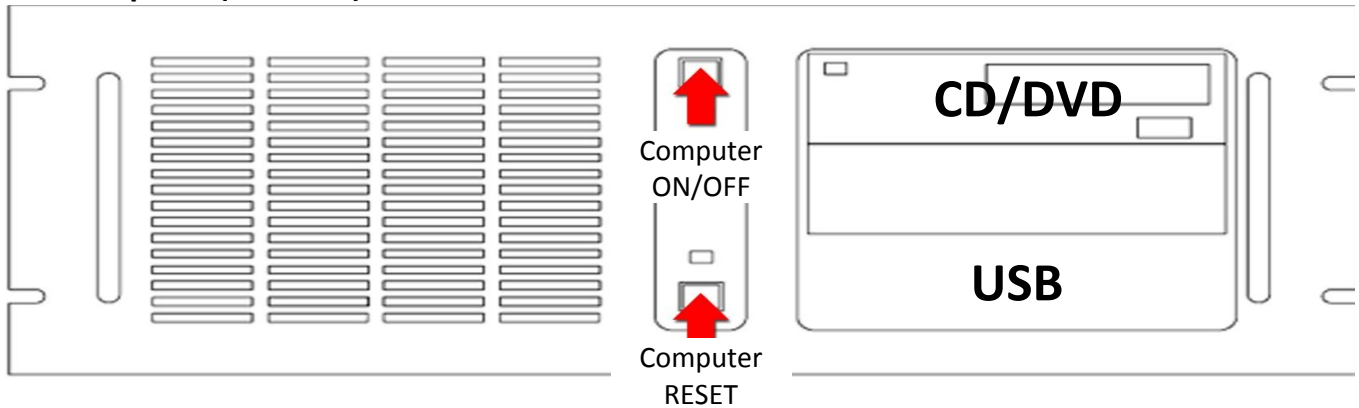

Using the computer

1. Turn on the projector(s) and the audio system.
2. Turn on the computer using the "ON/OFF" button.
3. Press the button labeled "Rack PC" on the Switcher.
4. The keyboard, mouse and wireless pointer will be in (1) of the (2) rack drawers.
Make sure to check *both drawers* in the a/v cabinet.
5. When you are finished turn off the computer, projector(s), and audio system.

VCR/DVD

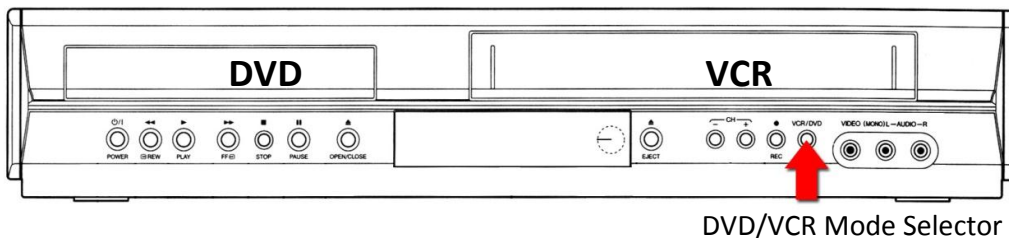

Showing a video tape or DVD...

1. Turn on the projector(s) and the audio system.
2. Press the "POWER" button to turn on the DVD/VCR.
3. Press the button labeled "DVD/VCR" on the Switcher.
4. Press the DVD/VCR mode selector button on the player to select VCR or DVD.
5. Insert your Tape or DVD and press play.
6. For extended DVD/VCR functions there is a remote control in (1) of the (2) rack drawers. Make sure to check *both drawers* in the a/v cabinet.

Please turn off the AV equipment when your class is over.